



# Suite 1419

**SYMPHONY**  
WORKPLACES

89 Headquarters Plaza North  
(43 Speedwell Ave.)  
Morristown NJ 07960

Work Smarter. The hybrid workplace of the future is here.

*Now*  
 Prebuilt and furnished  
 Flexible terms  
 Simple service agreement  
 Immediate occupancy  
 Professional services included  
 Established service provider  
 Variable office sizes as needed

*Before*  
 Major capital investment  
 Long lease lock-up  
 Complex leases with hidden escalations  
 Uncertain build out periods  
 Substantial full time admin expenses  
 Unreliable subleases  
 Fixed office space sizes

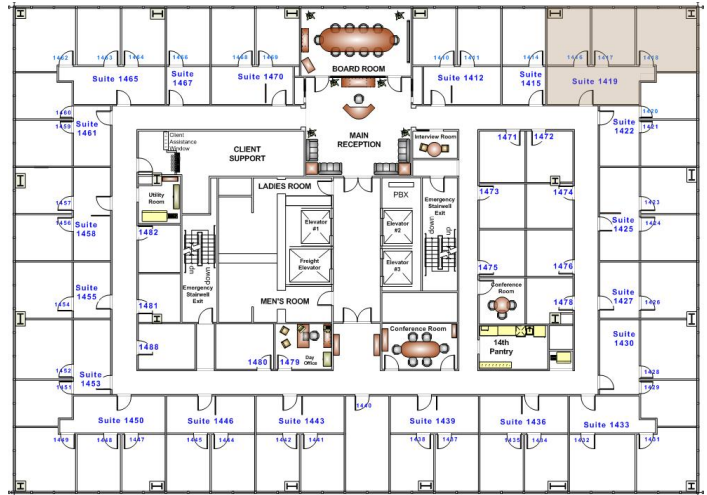

### Included in the Monthly Charge for this Unit

- Business Grade Wi-Fi Throughout
- Upgrade Finishes from Floor to Ceiling Throughout
- Custom Fit Geiger Furnishings
- Utilities and RE Taxes
- Directory Listing in the Building Lobby and throughout HQ Plaza Complex
- 24/7 Building and Office Access with Security System
- Private Mailbox and Daily Mail and Package Handling
- Available Voice and Broadband Communication Connections

### Amenities and Services Included with this Unit

- Professional On-Site Management and Administrative Services
- Reception Area with Concierge Service on the Floor
- Pantry Use and Beverage Service
- Daily Janitorial Services
- Conference Room Use
- Worldwide Business Center Access And more...

### Amenities Available within the Headquarters Plaza Complex

- Hyatt Hotel
- Health Club
- Underground Parking
- Food Court and Numerous Restaurants
- Child Care Center
- Walk to NY Train Station; County Courthouse; Morristown Green

### For More Information:

Nick Logothetis  
 Email: [sales@workplacesmail.com](mailto:sales@workplacesmail.com)  
 Phone: (973) 644-3000  
[www.njworkplaces.com](http://www.njworkplaces.com)

